

20-2177 Dual Motor Layout

This is a light layout that can be found in the following:

- 20-2177 Flynn Sofa

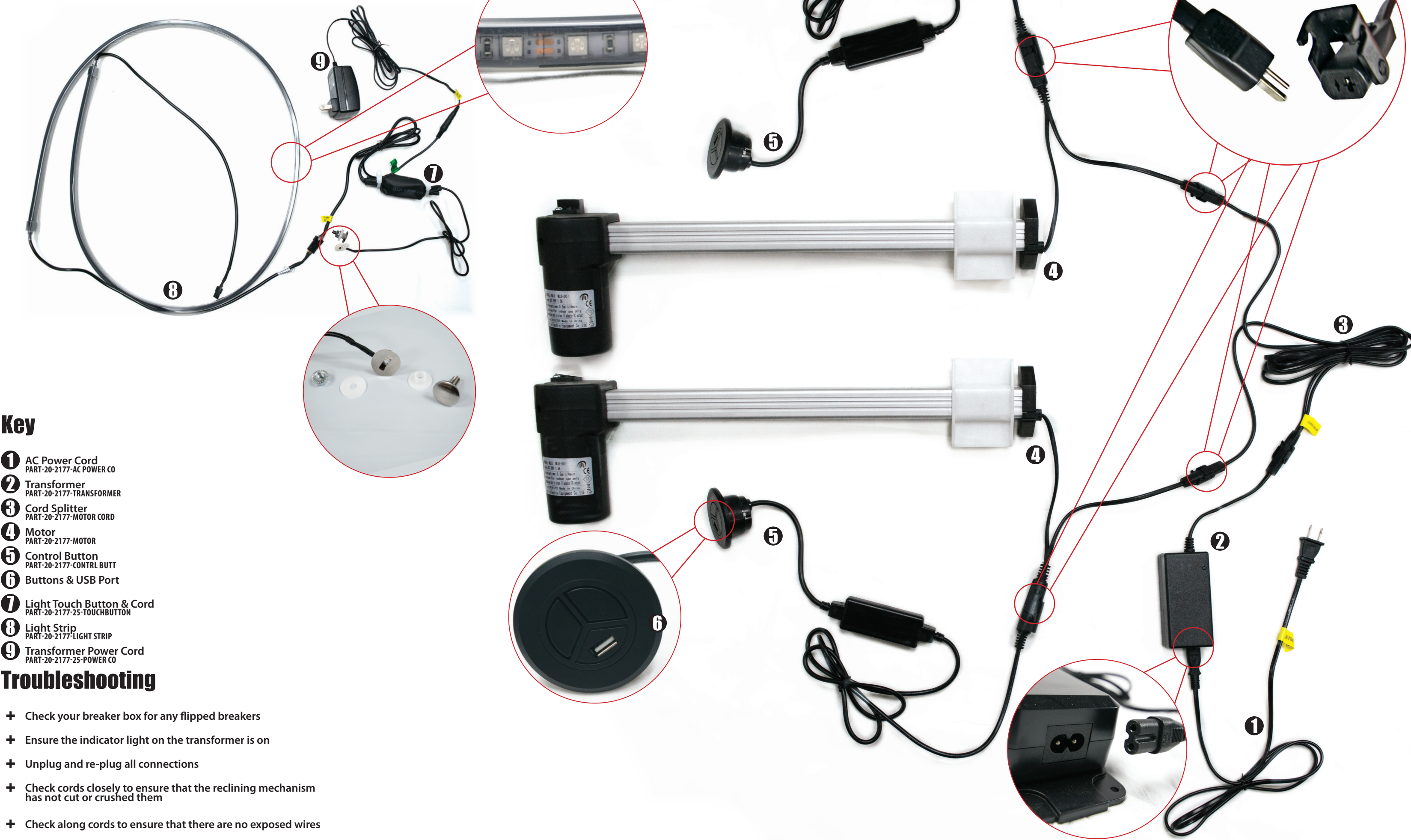

Key

- 1 AC Power Cord
PART-20-2177-AC POWER CO
- 2 Transformer
PART-20-2177-TRANSFORMER
- 3 Cord Splitter
PART-20-2177-MOTOR CORD
- 4 Motor
PART-20-2177-MOTOR
- 5 Control Button
PART-20-2177-CTRL BUTT
- 6 Buttons & USB Port
- 7 Light Touch Button & Cord
PART-20-2177-25-TOUCHBUTTON
- 8 Light Strip
PART-20-2177-LIGHT STRIP
- 9 Transformer Power Cord
PART-20-2177-25-POWER CO

Troubleshooting

- + Check your breaker box for any flipped breakers
- + Ensure the indicator light on the transformer is on
- + Unplug and re-plug all connections
- + Check cords closely to ensure that the reclining mechanism has not cut or crushed them
- + Check along cords to ensure that there are no exposed wires